

# Babylock Zest Sewing Machine

Name	Zest Sewing Machine
Training	Training Required
Manufacturer	Babylock
Description	Sewing Machine- Lockstitch

[blocked URL](#)

Training is required. After training, users should know:

- Identify basic parts of the sewing machine
- Understand how a stitch is formed
- Understand thread tension
- Understand needle selection
- Machine operation (below)

## Machine Operation Refresher Videos

### 1. Change needle

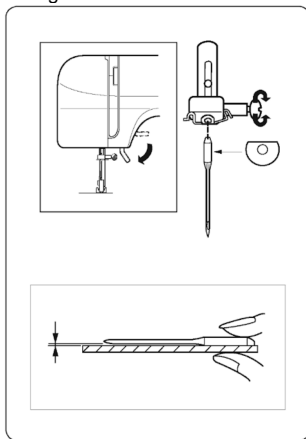

#### Changing the Needle

##### ⚠ CAUTION:

Turn OFF the power switch before changing the needle.

Raise the needle to its highest position by turning the handwheel counterclockwise.

A loose needle or a loose screw may cause machine malfunction or needle to break.

Loosen the needle clamp screw by turning it counterclockwise. Remove the needle from the needle clamp.

Insert a new needle into the needle clamp with the flat side to the rear. When inserting the needle into the needle clamp, push it up as far as it will go.

Tighten the needle clamp screw firmly by turning it clockwise.

- ① Needle clamp screw
- ② Flat side

#### Checking the needle

To see if the needle is in good condition, place the flat side of the needle onto something flat (needle plate, glass etc.). The gap between the needle and the flat surface should be consistent. Never use a bent or blunt needle.

A damaged needle can cause permanent snags or runs in knits, fine silks and silk-like fabrics.

2. Wind bobbin
3. Thread Lower machine
4. Thread upper machine & bring up thread
5. Start/end seams
6. Reverse
7. Cornering
8. Change stitch length or width

## Related Pages

# Machine Status

Machine Number	Name	Status	Date Checked	Person Checking
1	Babylock Zest			
2	Babylock Zest			
3	Babylock Zest			
4	Babylock Zest			
5	Babylock Zest			
6	Babylock Zest			